

Express Hanger

For the fast suspension of a variety of services, designed with an easy push-button release mechanism.

- The Express No.1 is ideal for signage, shopfitting, lighting, and other lightweight fixtures
- The Express No.2 is ideal for mechanical and electrical services
- Up to 6 times faster to install than traditional methods
- Discreet and aesthetic design
- Ergonomic push buttons are easy to use
- No Release Key required to adjust or level the service



Available in sizes No.1 - No.2



Supplied as ready-to-use kits with a length of cable, Express fastener, and end fixing of your choice.

5:1 SAFETY FACTOR	No.1	No.2
LOAD RATING PER HANGER	33 lbs	100 lbs

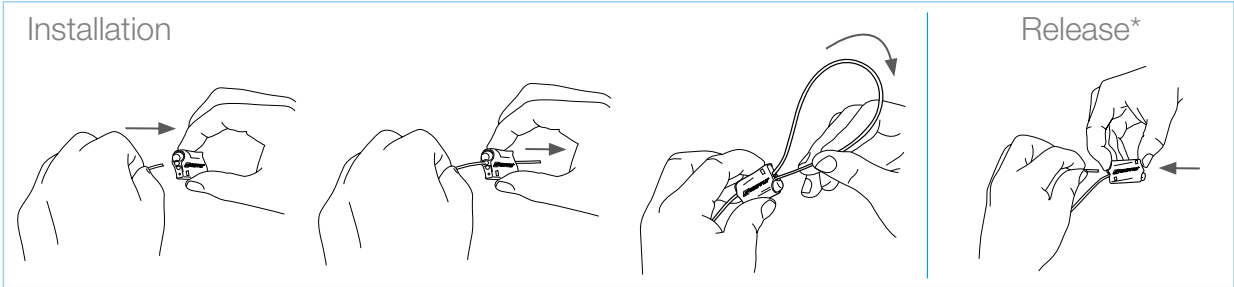

Angel Hanger

Designed for architectural lighting suspensions, signage, acoustic baffles, and installations where aesthetics are important.

- Simple one handed operation for easy height/leveling adjustment by pressing in on “wings”
- Contemporary design to complement the overall suspension
- Extensive range of cable end fixing options allowing installation into most structure or ceiling types
- Variety of feet options to enable attachment in different ways
- Uses 1/16" cable to make the suspension as visually discreet as possible



Available with a range of feet options



Supplied as ready-to-use kits with a length of cable, Angel fastener, and end fixing of your choice.

5:1 SAFETY FACTOR	No.1
LOAD RATING PER HANGER	33 lbs

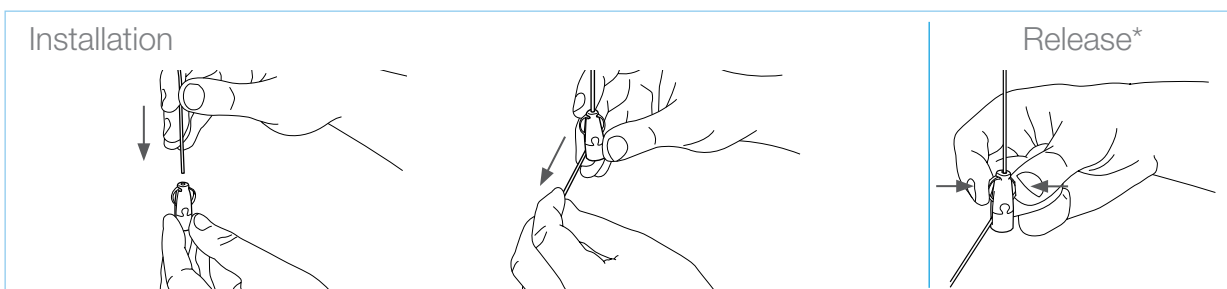

* When releasing: 1. Remove load, 2. Squeeze wings, 3. Raise or lower on cable

Angel Feet Options

The Angel fastener is extremely versatile, with a range of feet options available to suit every application.



Y-FIT

- Dual fixing points for balance
- Ideal for suspending light fixtures
- 6", 12" or 18" leg lengths as standard
- Various end fixing options for leg attachment to service



ADJUSTABLE Y-FIT

- Adjustable legs for balance
- Simple one handed operation for easy adjustment
- Various end fixing options for leg attachment to service



HOOK

- Ideal for light fittings, signage, or for use with eyebolts, spring, and wire anchors
- Integrated hook with 1/8" clearance
- Safety clasp for security
- Side cable exit



SIGNAGE

- Ideal for signage up to 3/16" in thickness
- Grub screw for direct attachment
- Side cable exit



SWIVEL

- Swivel feature for suspension at angles up to 90°
- Available in 1/4" thread
- Female: maximum insertion depth 1/4"
- Male: 9/16" exposed thread length as standard
- Side cable exit



SIDE EXIT FEMALE

- Female threaded foot, ideal for direct attachment to light fittings, frames and acoustic panels
- Available 1/4" thread
- Maximum insertion depth 1/4"
- Side cable exit



SIDE EXIT MALE

- Threaded male foot, ideal for direct attachment to light fittings, frames and acoustic panels
- Available in 1/4" thread as standard.
- 9/16" exposed thread length as standard, custom lengths on request
- Side cable exit (Center exit also available)



KNOCKOUT

- Ideal for strip lighting with standard 7/8" knockout holes
- Slots into knockout centers and twists to lock into place
- No tools needed, or the need to remove the back of the fixture



4 POINT

- Ideal for light panels with multi fixing points
- Perfect for even balance of square modules
- Side wire exit
- Four Point disc diameter 0.63"



HELIX

- Ideal for use with acoustic panels made from fiberglass and dense foam
- Angel connects to Helix with quick twist for faster installation



MINI HELIX

- The helical screw binds layers of polyester fiber to form a strong anchoring point
- With the hanger and anchor pre-assembled, installation time is reduced
- Swivel up to 45 degrees to avoid existing services or suspend circular panels



T19

- Includes a 0.55 in / 14 mm washer
- Rectangular t-foot fits a wide range of tracks.
- Threaded foot attachment allows installer to tighten Angel body by hand

Supplied as ready-to-use kits with a length of cable, Angel Hanger, and end fixing of your choice.

Hanger Kit Codes

How to work out your unique product code

1

CHOOSE YOUR PRODUCT



Standard Hanger No.1
HF1



Standard Hanger No.2
HF2



Standard Hanger No.3
HF3



Standard Hanger No.4
HF4



Standard Hanger No.5
HF5



Express No.1
XP1



Express No.2
XP2



Angel Male Side Exit
AL1-SM14



Angel Male Center Exit
AL1-CM14



Angel Swivel
AL1-SF1/4W
AL1-SM1/4W



Angel Female
AL1-SF14



Angel Hook
AL1-ISH



Angel Y-Fit
AL1-YTG 300*
*Also available in 150 and 460 mm leg lengths.



Adjustable Y-Fit
AL1-YTG A300*



Angel 4-Point
AL1-FPTG300



Angel Signage
AL1-SL5



Angel Knockout
AL1-KO



Angel Helix
AL1-SHX



Angel Mini Helix
AL1-SMHX



Angel T19
AL1-ST19



Stainless Steel Hanger No. 2-3
HF2, HF3

2

CHOOSE YOUR END FIXING



Loop
LG



Stainless Steel Loop
LS



Stud
S*G



Stainless Steel Stud
SQS



Toggle
TQG
TG



Stainless Steel Toggle
TS



Hook
HG



Stainless Steel Hook
HS



Mini Hook
MHG



Eyelet
EYQG



45° Eyelet
EY45/8G



90° Eyelet
EY90°G



C-Clip 1/8"
CC-1/8



C-Clip 1/4"
CC-1/4



Top Hat Barrel
BB14

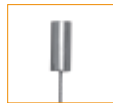

Barrel
B*G



End Stop
EG



Cladding Hook
CHG



Ceiling Anchor
CWHQ



Karabiner
KG



Shot Fire
SF35



Shot Fire for Post Tension Concrete
C945



Shot Fire for Post Tension Concrete
NS45



Swivel Toggle
STG
For use with Spider only



Spider Cast-in-Place Insert
SX-WF
* Add the code SXWF after cable length, for example: HF2-STG-5FT-SXWF



Metal Deck Insert
SX-MD
* Add the code SXMD after cable length, for example: HF2-STG-5FT-SXMD

* Stud available in 1/4" or 3/8". Barrel available in 1/4" or 3/8".

90 Degree Eyelet available in 1/4" or 3/8".

In place of asterisk in code, enter Q for 1/4" or 3/8 for 3/8".

3

CHOOSE YOUR CABLE LENGTH

5FT

10FT

15FT

20FT

30FT

Enter your unique product code (e.g. XP2-LG-10FT):

PRODUCT

END FIXING

CABLE LENGTH